

INSTRUCTIONS

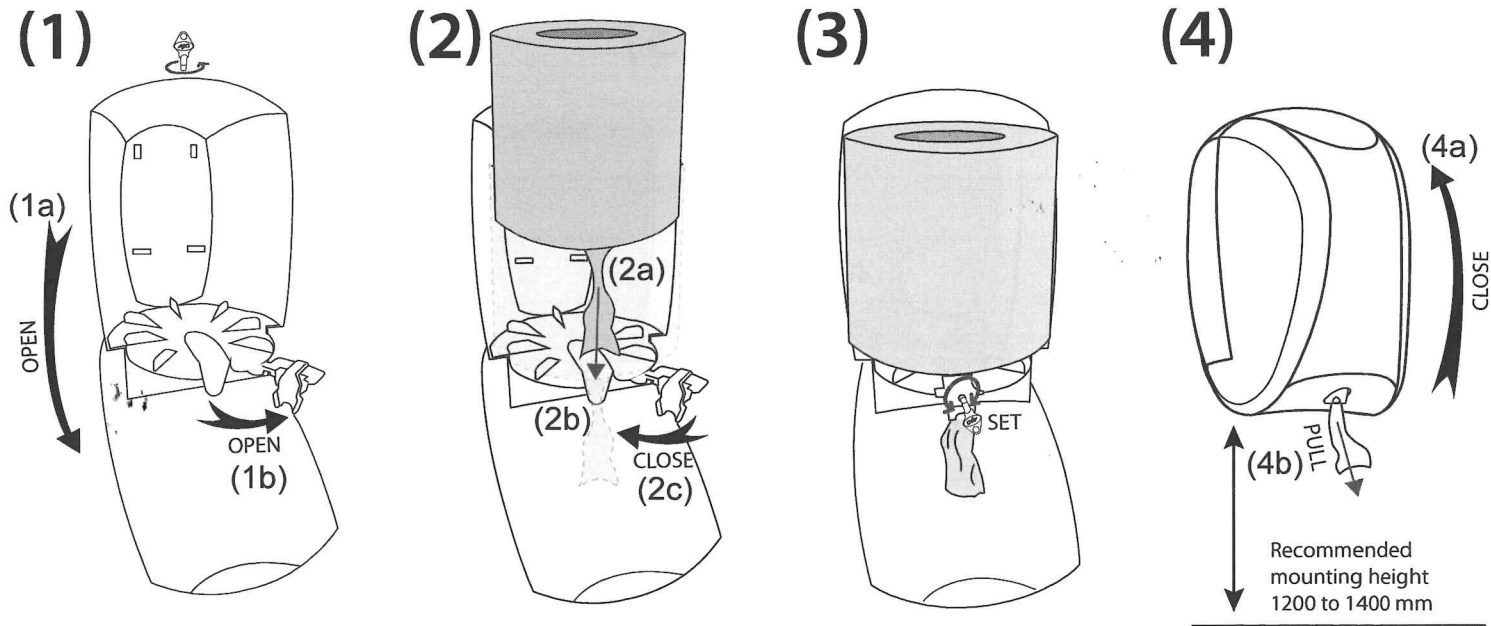

- 1) Open the dispenser (1a) with MP key; open the door (1b).
- 2) Pull out from the inside of the roll of paper about 10 cm. manually (2a); insert the flap in the appropriate slot (2b); close the door (2c)
- 3) Using the MP key, adjust the paper supply according to the paper grammage..
- 4) Close the dispenser (4a) and pull out the first sheet of pre-cut paper (4b).